

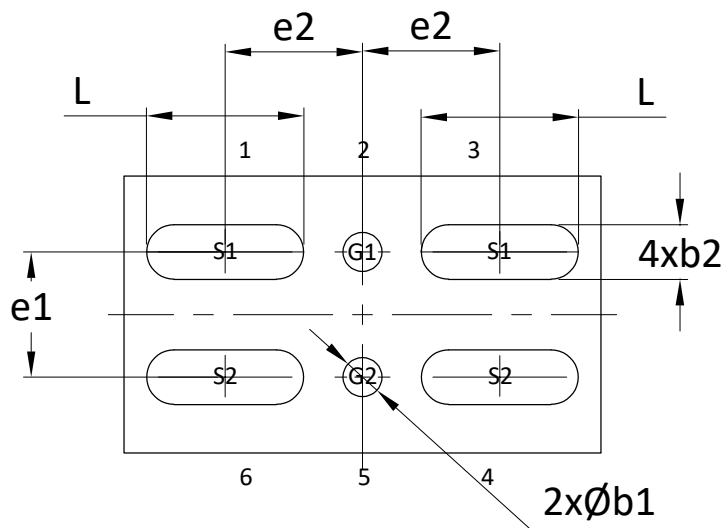

AlphaDFN3.05x1.77A_6 PACKAGE OUTLINE

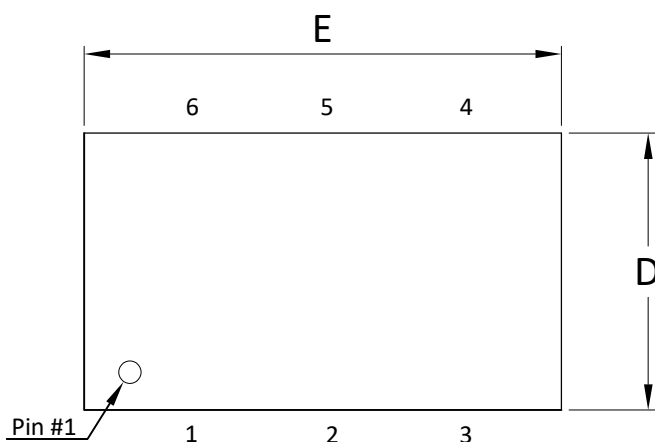

Bottom View



Top View

RECOMMENDED LAND PATTERN

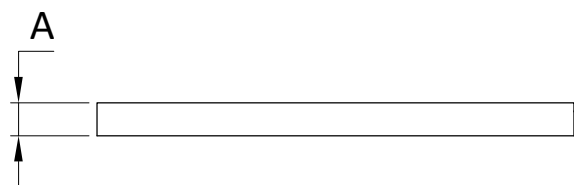
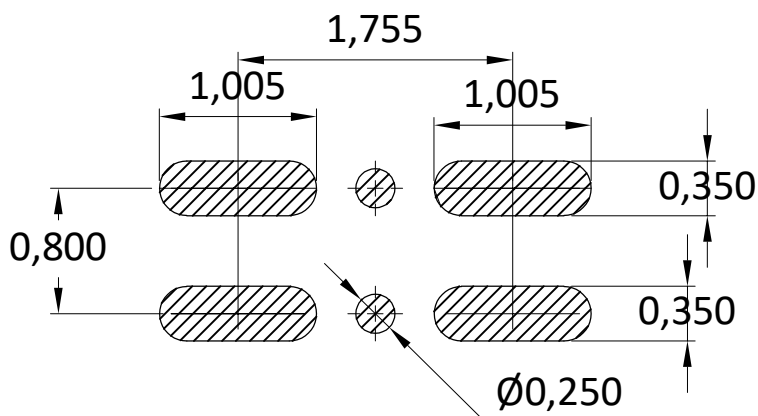

Side View

SYMBOLS	DIMENSIONS IN MILLIMETERS			DIMENSIONS IN INCHES		
	MIN	NOM	MAX	MIN	NOM	MAX
A	-	-	0.250	-	-	0.010
b1	0.220	0.250	0.280	0.009	0.010	0.011
b2	0.320	0.350	0.380	0.013	0.014	0.015
D	1.720	1.770	1.820	0.068	0.070	0.072
E	3.000	3.050	3.100	0.118	0.120	0.122
L	0.975	1.005	1.035	0.038	0.040	0.041
e1	0.800 BSC			0.031 BSC		
e2	0.878 BSC			0.035 BSC		

NOTE:

1. CONTROLLED DIMENSIONS ARE IN MILLIMETERS. CONVERTED INCH DIMENSIONS ARE NOT NECESSARILY EXACT.
2. THE SCRIBBLE LINE IS NOT INCLUDED IN THE POD, IF WITH SCRIBBLE LINE, D AND E DIMENSION WILL PLUS 0.05MM RESPECTIVELY.
3. THIS PACKAGE WAS QUALIFIED USING IR REFLOW PROCESS (JEDEC STANDARD). FOR USAGE IN OTHER SOLDERING PROCESSES, PLEASE CONTACT LOCAL AOS REPRESENTATIVES