

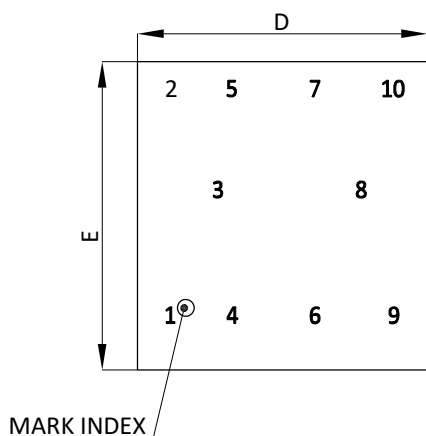

AlphaDFN1.84x1.96_10 PACKAGE OUTLINE

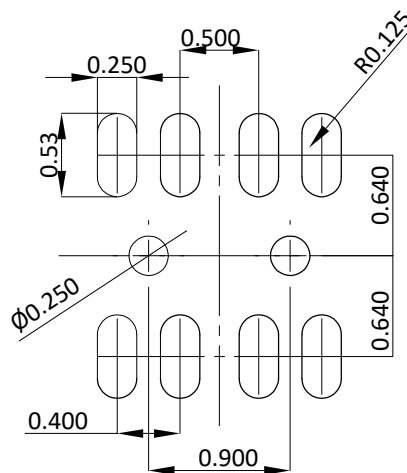

TOP VIEW



RECOMMENDED LAND PATTERN

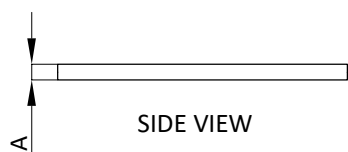

SIDE VIEW

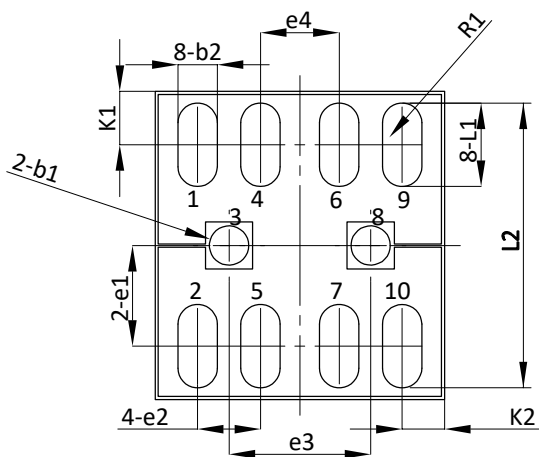

BOTTOM VIEW

SYMBOLS	DIM. IN MM			DIM. IN INCH		
	MIN.	NOM.	MAX.	MIN.	NOM.	MAX.
A	---	0.100	0.130	---	0.004	0.005
b1	0.220	0.250	0.280	0.009	0.010	0.011
b2	0.220	0.250	0.280	0.009	0.010	0.011
D	1.810	1.840	1.870	0.071	0.072	0.074
E	1.930	1.960	1.990	0.076	0.077	0.078
e1	0.640BSC.			0.025BSC.		
e2	0.400BSC.			0.016BSC.		
e3	0.900BSC.			0.035BSC.		
e4	0.500BSC.			0.020BSC.		
L1	0.500	0.530	0.560	0.020	0.021	0.022
L2	1.780	1.810	1.840	0.070	0.071	0.072
R1	---	0.125	---	---	0.005	---
K1	---	0.340	---	---	0.013	---
K2	---	0.270	---	---	0.011	---

NOTE:

1. CONTROLLED DIMENSION IS IN MILLIMETER.
2. THE SCRIBE LINE DIMENSION IS NOT INCLUDED IN THE POD.
3. THIS PACKAGE WAS QUALIFIED USING IR REFLOW PROCESS (JEDEC STANDARD). FOR USAGE IN OTHER SOLDERING PROCESSES, PLEASE CONTACT LOCAL AOS REPRESENTATIVES.